

CEC

CIVIL ENGINEERING CONSULTANTS

D O N D U R D E N , I N C .

11550 I.H. 10 WEST, SUITE 395

SAN ANTONIO, TEXAS 78230

P) 210.641.9999

F) 210.641.6440

Website: [www.cec-texas.com](http://www.cec-texas.com)

T.B.P.E. REGISTRATION NO. F-2214

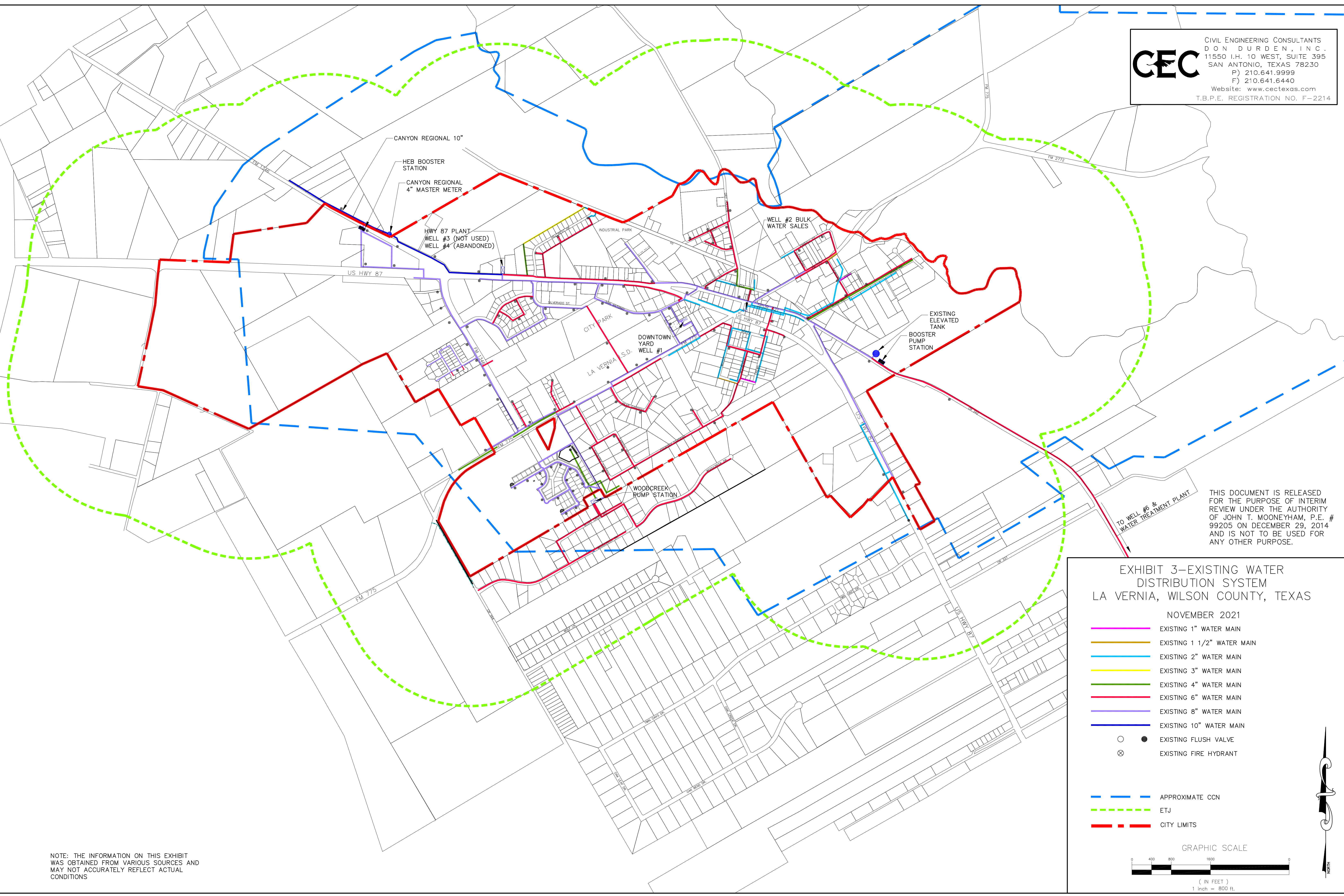

THIS DOCUMENT IS RELEASED FOR THE PURPOSE OF INTERIM REVIEW UNDER THE AUTHORITY OF JOHN T. MOONEYHAM, P.E. # 99205 ON DECEMBER 29, 2014 AND IS NOT TO BE USED FOR ANY OTHER PURPOSE.

EXHIBIT 3—EXISTING WATER DISTRIBUTION SYSTEM  
LA VERNIA, WILSON COUNTY, TEXAS

NOVEMBER 2021

- EXISTING 1" WATER MAIN
- EXISTING 1 1/2" WATER MAIN
- EXISTING 2" WATER MAIN
- EXISTING 3" WATER MAIN
- EXISTING 4" WATER MAIN
- EXISTING 6" WATER MAIN
- EXISTING 8" WATER MAIN
- EXISTING 10" WATER MAIN
- EXISTING FLUSH VALVE
- EXISTING FIRE HYDRANT

- APPROXIMATE CCN
- ETJ
- CITY LIMITS

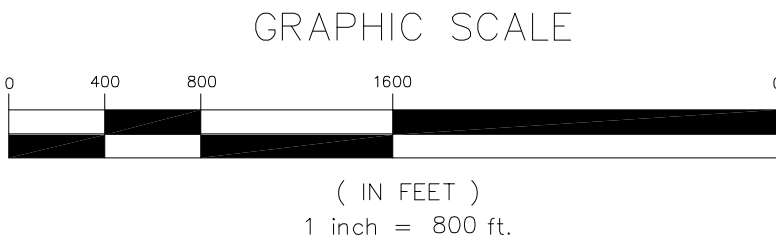

NOTE: THE INFORMATION ON THIS EXHIBIT WAS OBTAINED FROM VARIOUS SOURCES AND MAY NOT ACCURATELY REFLECT ACTUAL CONDITIONS